



SERVICE PARTS LIST

BULLETIN NO.
54-40-2581

SPECIFY CATALOG NO. AND SERIAL NO. WHEN ORDERING PARTS		REVISED BULLETIN	DATE
M18™ FUEL™ Hatchet™ Pruning Saw		54-40-2580	Jan. 2025
CATALOG NO.	3004-20	STARTING SERIAL NO.	N10B
WIRING INSTRUCTION SEE PAGE 2			

FIG.	PART NO.	DESCRIPTION OF PART	NO. REQ.
1	49-62-0017	Scabbard	(1)
2	49-16-2750	8" Chain (Accessory)	(1)
3	43-54-0050	Knuckle Guard	(1)
4	49-16-2751	8" Guide Bar (Accessory)	(1)
6	44-52-0018	Sealing Pad	(1)
7	05-55-5001	M8 Flange Nut	(1)
8	-----	Chain Cover	(1)
9	-----	Handle Support - Right	(1)
10	42-70-5268	E-Ring	(1)
11	45-88-7001	Chain Washer	(1)
12	45-44-0212	Sprocket	(1)
13	06-65-0093	Lock-Off Pin	(1)
14	-----	Lock-Off Button	(1)

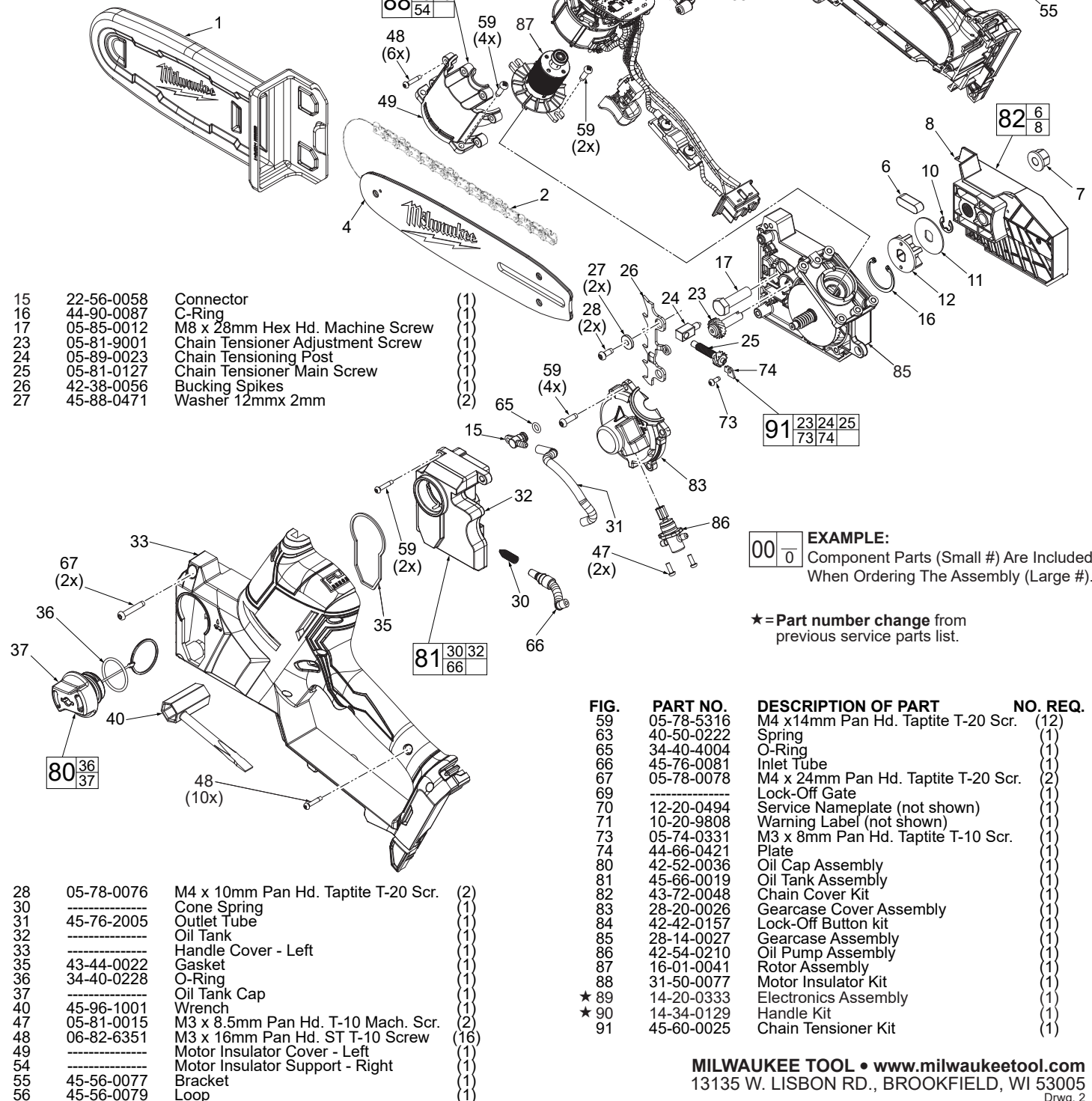

EXAMPLE:
Component Parts (Small #) Are Included
When Ordering The Assembly (Large #).

★ = Part number change from
previous service parts list.

FIG.	PART NO.	DESCRIPTION OF PART	NO. REQ.
59	05-78-5316	M4 x14mm Pan Hd. Taptite T-20 Scr.	(12)
63	40-50-0222	Spring	(1)
65	34-40-4004	O-Ring	(1)
66	45-76-0081	Inlet Tube	(1)
67	05-78-0078	M4 x 24mm Pan Hd. Taptite T-20 Scr.	(2)
69	-----	Lock-Off Gate	(1)
70	12-20-0494	Service Nameplate (not shown)	(1)
71	10-20-9808	Warning Label (not shown)	(1)
73	05-74-0331	M3 x 8mm Pan Hd. Taptite T-10 Scr.	(1)
74	44-66-0421	Plate	(1)
80	42-52-0036	Oil Cap Assembly	(1)
81	45-66-0019	Oil Tank Assembly	(1)
82	43-72-0048	Chain Cover Kit	(1)
83	28-20-0026	Gearcase Cover Assembly	(1)
84	42-42-0157	Lock-Off Button kit	(1)
85	28-14-0027	Gearcase Assembly	(1)
86	42-54-0210	Oil Pump Assembly	(1)
87	16-01-0041	Rotor Assembly	(1)
88	31-50-0077	Motor Insulator Kit	(1)
★ 89	14-20-0333	Electronics Assembly	(1)
★ 90	14-34-0129	Handle Kit	(1)
91	45-60-0025	Chain Tensioner Kit	(1)

MILWAUKEE TOOL • www.milwaukeetool.com
13135 W. LISBON RD., BROOKFIELD, WI 53005
Drwg. 2

As an aid to reassembly, take notice of wire routings and position in wire guides and traps while dismantling tool.

Be sure that all components of electronics kit are seated firmly and squarely in housing recesses.

Avoid pinched wires, be sure that all wires and sleeves are pressed completely down in wire traps.

Prior to securing housing cover onto the housing support, be sure that there are no interferences.

Before installing the battery, check for proper functionality of shuttles and triggers.

Install battery and depress switch triggers to assure tool is operating properly.

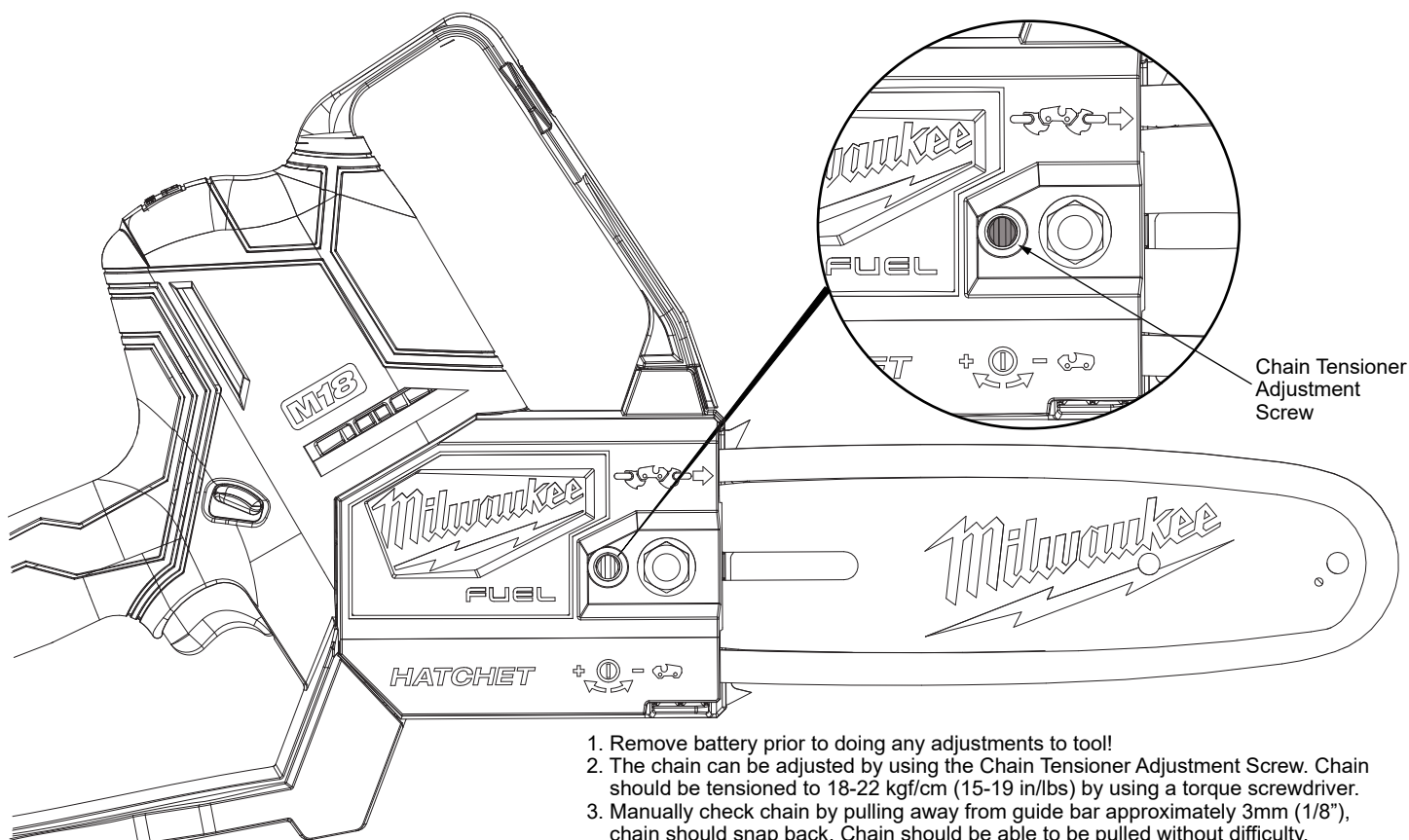
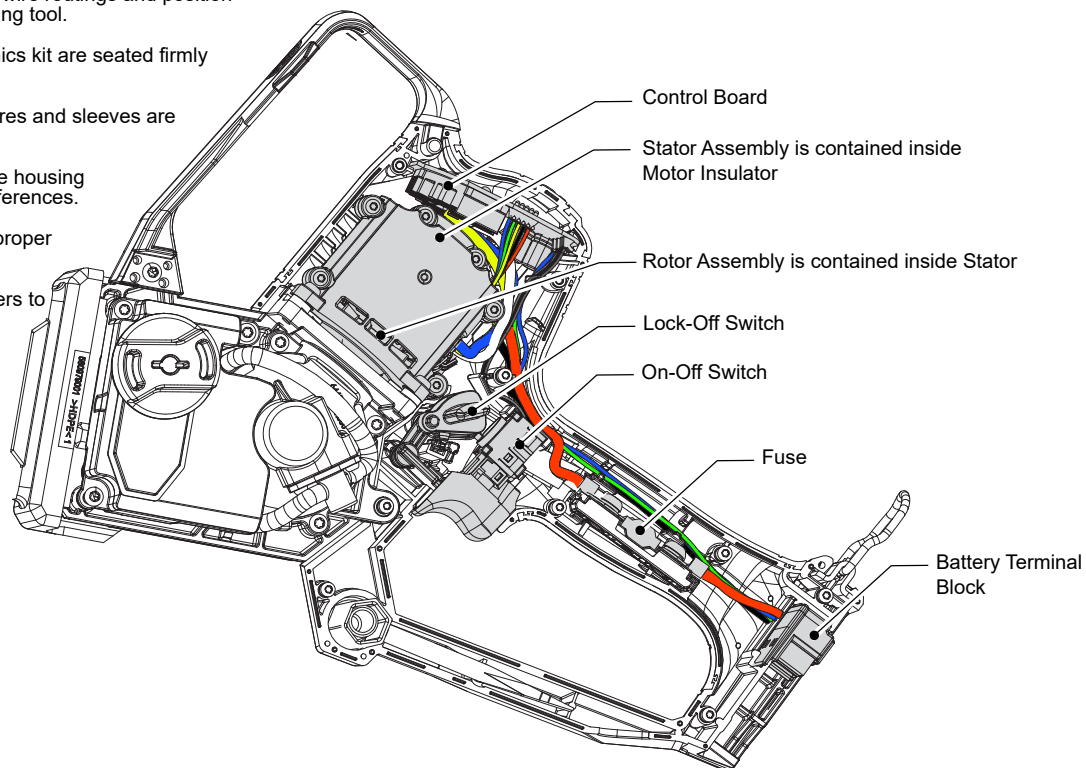

SCREW TORQUE SPECIFICATIONS				
FIG.	PART NO.	WHERE USED	SEAT TORQUE	
			(kgf-cm)	(lb-in)
7	05-55-5001	Chain Cover	50±5	43±4
28	05-78-0076	Bucking Spike	25±3	22±3
47	05-81-0015	Oil Pump	6±1	5±1
48	06-82-6351	Handle Cover & Insulator	10±2	9±2
59	05-78-5316	Gearcase Cover & Rotor	25±3	22±3
59	05-78-5316	Insulator Cover	19±2	16±2
59	05-78-5316	Oil Tank	15±2	13±2
67	05-78-0078	Handle Cover	25±3	22±3
73	05-74-0331	Chain Tensioner	11±2	10±3

Lubrication

