

SERVICE BILL OF MATERIAL (BOM) LISTING

FIG.	PART NO.	DESCRIPTION OF PART	NO. REQ.
1	-----	Back Handle Support	(1)
2	-----	Back Handle Cover	(1)
3	-----	Front Handle Cover	(1)
4	-----	Front Handle Support	(1)
5	42-42-0011	Safety Button	(1)
6	-----	Spring	(1)
7	45-72-9362	Trigger	(1)
8	-----	Wire Cover	(1)
9	06-82-1080	M3 x 14mm Pan Hd Screw	(2)
10	-----	Finger Clearance Slide (Rotation Lock Button)	(1)
11	-----	Spring for Slide	(1)
12	-----	M4 x 16mm PH Torx T-20 B Screw	(12)
13	-----	Ball Bearing	(1)
14	-----	Rotor	(1)
17	-----	Motor Housing Support	(1)
18	-----	Motor Housing Cover	(1)
19	06-82-6351	M3 x 16mm PH Torx T-10 B Screw	(6)
20	34-80-1120	Retaining Ring	(1)
21	-----	M4 x 12mm PH Torx T-20 Screw	(10)
22	-----	Motor Mount	(1)
24	-----	Needle Bearing	(3)
25	-----	Planet Gear	(3)
26	-----	Ring Gear	(1)
27	-----	Carrier	(1)
28	-----	Gearcase	(1)
29	-----	Rear Spindle Ball Bearing	(1)
30	-----	Wear Plate Upper Gearcase	(1)
31	-----	Wear Plate Lower Gearcase	(1)
32	05-74-0144	M3 x 5mm M Screw	(5)
33	14-09-6147	Crankshaft	(1)
34	30-94-5841	Connecting Rod	(2)
35	-----	Upper Wear Plate Gearcase Cover	(1)
36	-----	Lower Wear Plate Gearcase Cover	(1)
37	-----	Ball Bearing	(1)
38	-----	Gearcase Cover	(1)
39	05-85-0080	M8 x 1.25 M Screw	(1)
40	05-78-0033	M5 x 20mm M Screw	(6)
41	45-06-4572	Felt Seal	(2)
42	-----	Bottom Front Cover	(1)
43	06-82-0186	M4 x 10mm PH Torx T-20 M Screw	(8)
44	-----	M4 x 16mm PH Torx T-20 M Screw	(4)
45	-----	Bail Handle Support	(1)
46	-----	Gasket For Switch	(1)
47	06-82-1087	M3 x 12mm PH Torx T-10 B Screw	(1)
48	-----	Spring Clip	(1)
49	-----	Trigger Bail Handle	(1)
50	-----	Bail Handle Cover	(1)
51	-----	M4 x 16mm PH Torx T-20 B Screw	(7)
52	-----	Hand Guard	(1)
53	06-82-2259	M5 x 30mm Hexagon Rec. M Screw	(2)
54	42-40-0019	Bushing	(2)
55	31-01-4808	24 inch Sweep Attachment	(1)
56	31-55-0749	24 inch Sheath	(1)
57	-----	24 inch Blade Assembly	(1)
58	05-88-0106	M2 x 5.5mm CH Torx T-8 PT Screw	(4)
61	-----	PCBA and Stator	(1)
68	12-20-1920	Service Nameplate	(1)
70	10-22-1979	Warning Label	(1)
71	10-22-1980	Warning Label	(1)
75	-----	Tip Guard	(1)
76	-----	M4 x 10mm PHTorx T-20 M Screw	(2)
80	42-41-0941	24 inch Blade Kit	(1)
82	14-32-5306	Hand Guard Kit	(1)
83	14-34-6251	Bail Handle Kit	(1)
84	14-50-2881	Motor Insulator Kit	(1)
85	14-34-6252	Handle Cover Kit	(1)
86	31-50-6581	Housing Kit	(1)
87	31-40-5248	Gearcase Cover Kit	(1)
88	31-15-2482	Wire Cover Kit	(1)
89	31-15-2481	Bottom Cover Kit	(1)
90	42-42-6478	Safety Button Kit	(1)
91	43-54-8521	Blade Tip Guard Kit	(1)
92	14-20-5984	Electronics Assembly	(1)
94	16-01-5339	Rotor Assembly	(1)
95	14-46-2558	Bearing Assembly	(1)
96	23-30-4626	Rotor / Motor Assembly	(1)
97	45-72-0920	Slide Kit	(1)

00 0

EXAMPLE:

Component Parts (Small #)
Are Included When Ordering
The Assembly (Large #).

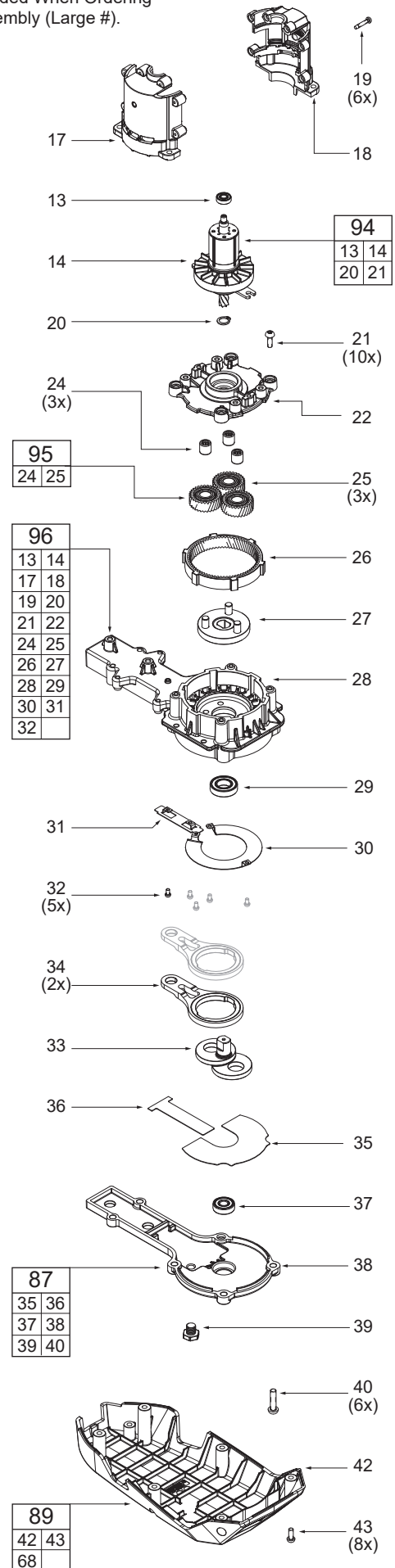

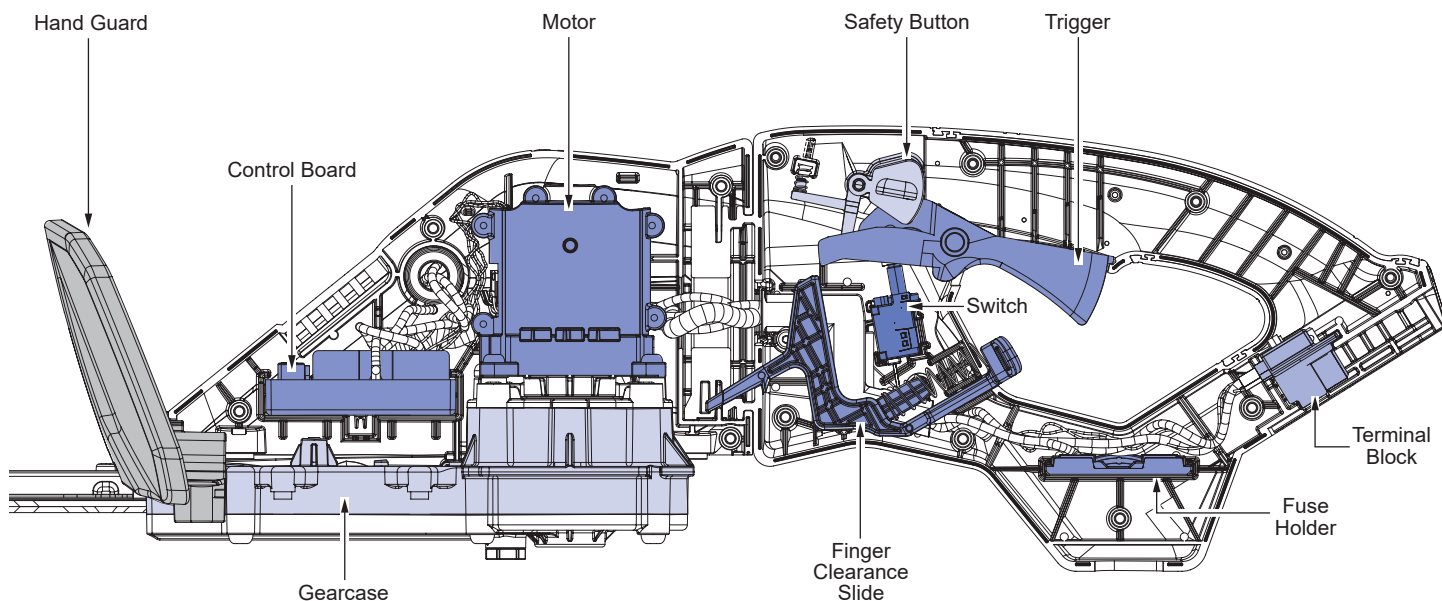

WARNING

- Take notice of wire routing and position in wire guides and traps while dismantling tool.
- Be sure that all components of the electronics kit are seated firmly and squarely in housing recesses.
- Avoid pinched wires, be sure all wires and sleeves are pressed completely down in wire guides and traps.
- Prior to installing housing cover onto handle support, be sure that there are no interferences.
- Be sure to check for proper functionality of switches and buttons after housing halves have been secured.

SCREW TORQUE SPECIFICATIONS

FIG.	PART NO.	DESCRIPTION OF FASTENER	WHERE USED	SEAT TORQUE	
				(kgf-cm)	(lb-in)
9	06-82-1080	M3 x 14mm Pan Hd. Screw	Wire Cover	6 ± 1	5 ± 0.9
12	-----	M4 x 16mm Pan Hd. Torx T-20 B Screw	Back and Front Handle Support	9 ± 1	8 ± 0.9
19	06-82-6351	M3 x 16mm Pan Hd. Torx T-10 B Screw	Motor Housing	9 ± 1	8 ± 0.9
21	-----	M4 x 12mm Pan Hd. Torx T-20 Screw	Motor Housing Mount	24 ± 3	21 ± 2.6
21	-----	M4 x 12mm Pan Hd. Torx T-20 Screw	Bearing Plate / Motor Mount	30 ± 3	26 ± 2.6
32	05-74-0144	M3 x 5mm M Screw	Wear Plate (item 30 & 31)	8 ± 1	7 ± 0.9
39	05-85-0080	M8 x 1.25 M Screw	Grease Port Plug	60 ± 6	52 ± 5
40	05-78-0033	M5 x 20mm M Screw	Gearcase Cover	60 ± 6	52 ± 5
43	06-82-0186	M4 x 10mm Pan Hd. Torx T-20 M Screw	Bottom Front Cover / Hand Guard	12 ± 1	10 ± 0.9
44	-----	M4 x 16mm Pan Hd. Torx T-20 M Screw	Bail Handle	24 ± 3	20 ± 2.6
47	06-82-1087	M3 x 12mm Pan Hd. Torx T-10 B Screw	Zipper Switch	3.5 ± 0.5	3 ± 0.4
51	-----	M4 x 16mm Pan Hd. Torx T-20 B Screw	Bail Handle Assembly	18 ± 2	15 ± 1.7
53	06-82-2259	M5 x 30mm Hexagon Rec. M Screw	Blade Gearcase	90 ± 9	78 ± 7.8
58	05-88-0106	M2 x 5.5mm Cap Hd. Torx T-8 PT Screw	Hall Board	3 ± 0.5	2.6 ± 0.4

SCREW TIGHTENING SEQUENCE

STEP 1 - Bottom Front Cover

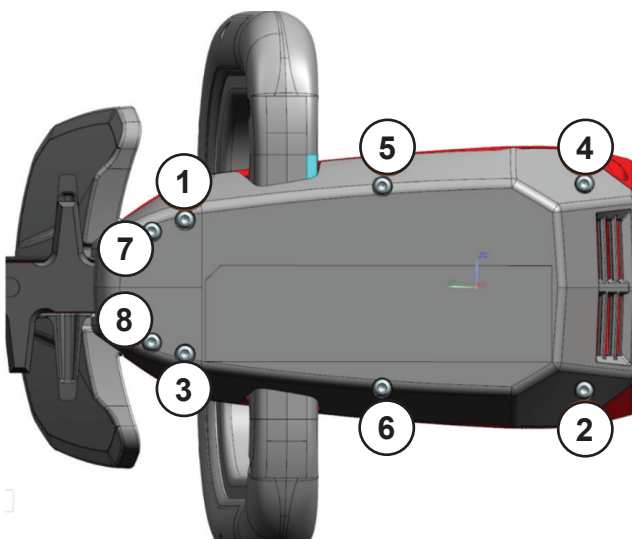

STEP 2 - Gearcase Cover

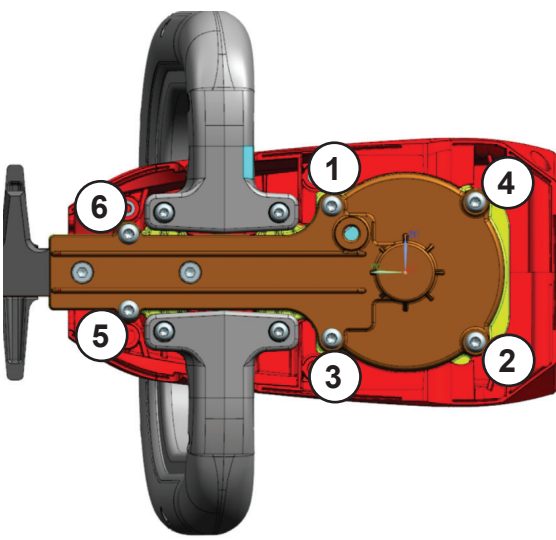

STEP 3 - Bail Handle Bottom

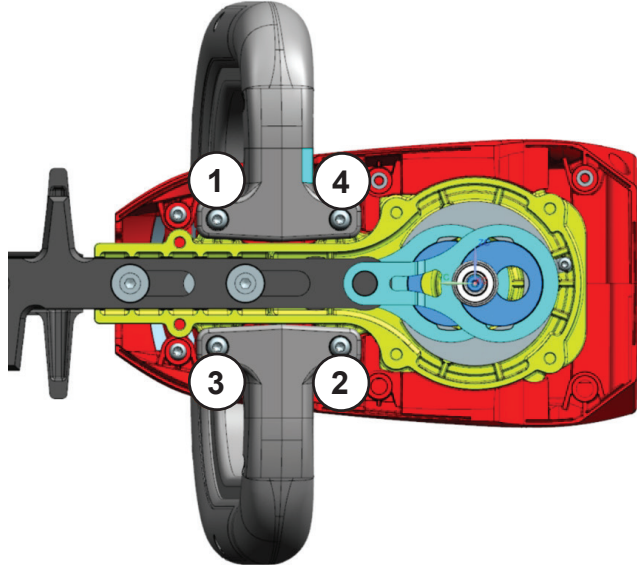

STEP 4 - Front Handle Cover

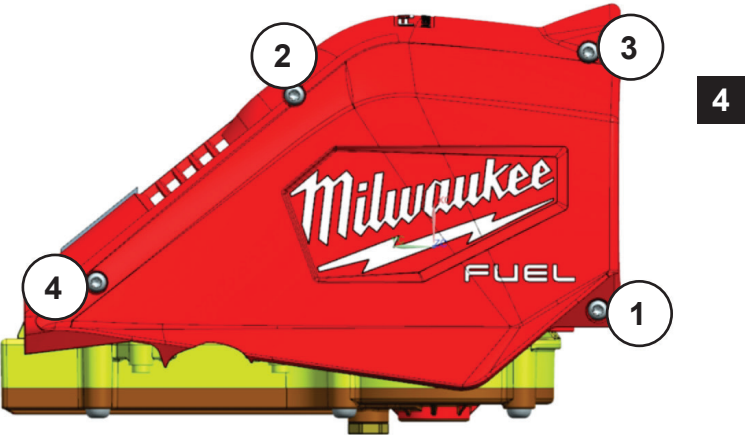

STEP 5 - Back Handle Cover

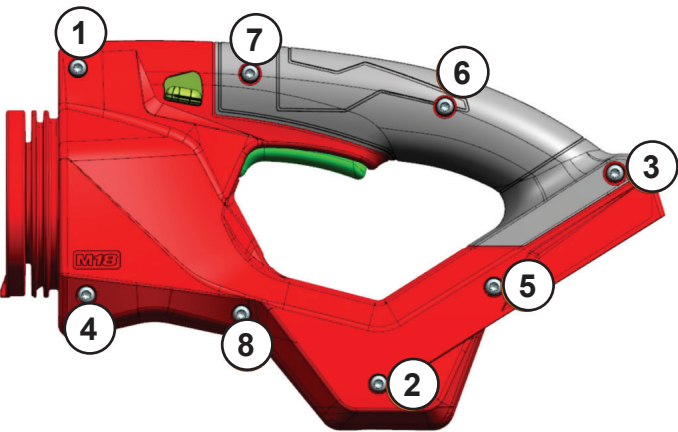

STEP 6 - Back Handle Support

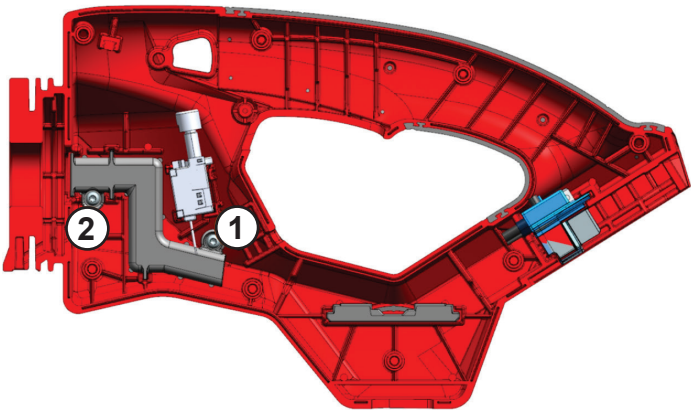

SCREW TIGHTENING SEQUENCE - Continued

STEP 7 - Bail Handle

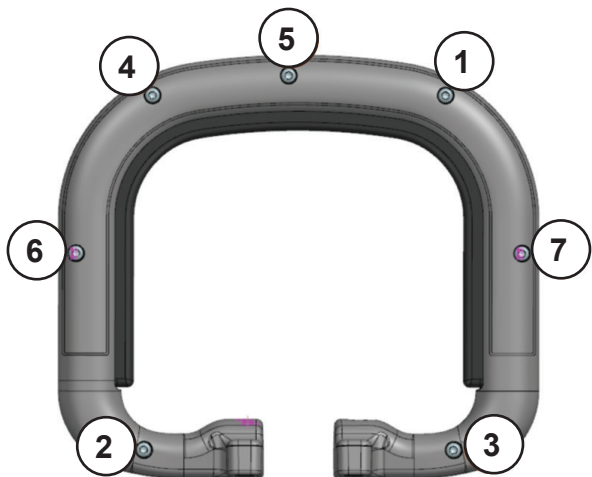

STEP 8 - Gearcase Cover

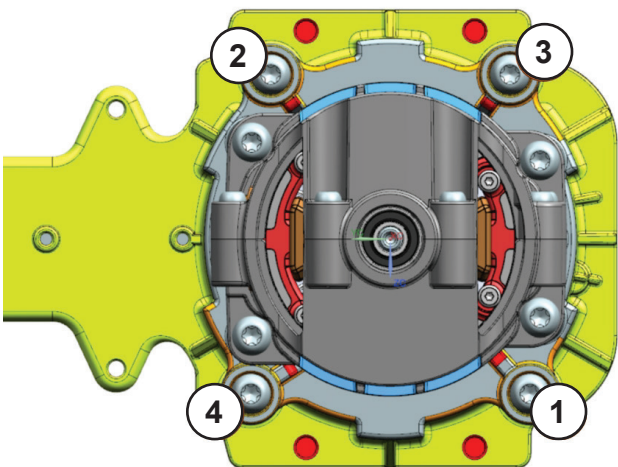

STEP 9 - Upper & Lower Wear Plates

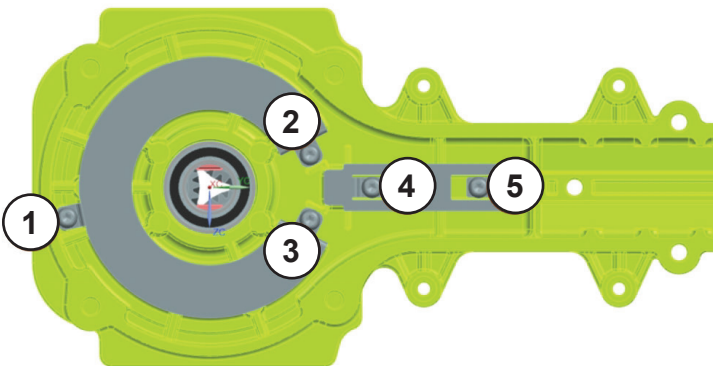

STEP 10 - Motor Housing

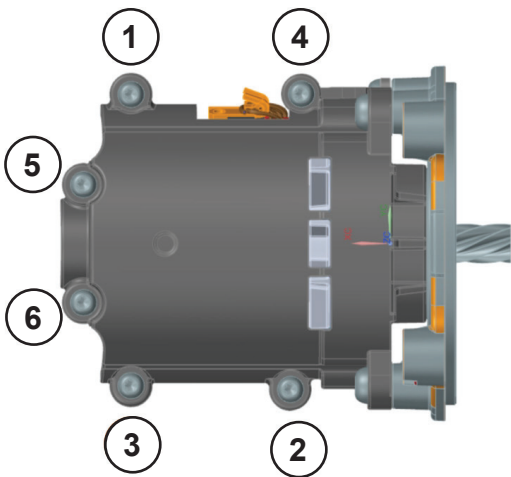

5

STEP 11
- Motor Housing

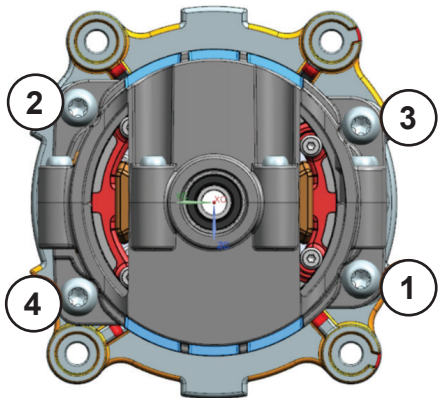

STEP 12
- Motor Housing

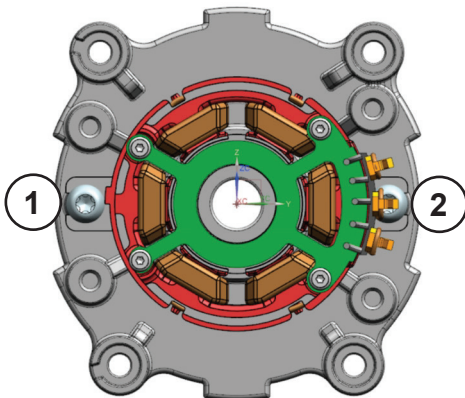

STEP 13
- Stator

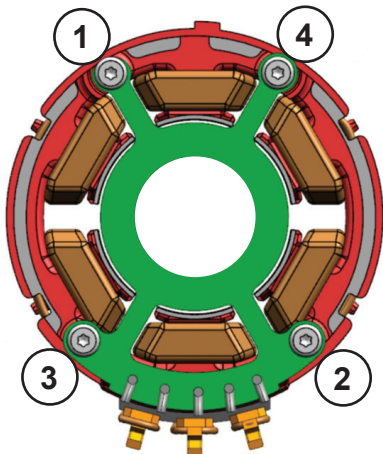

WIRING INSTRUCTIONS

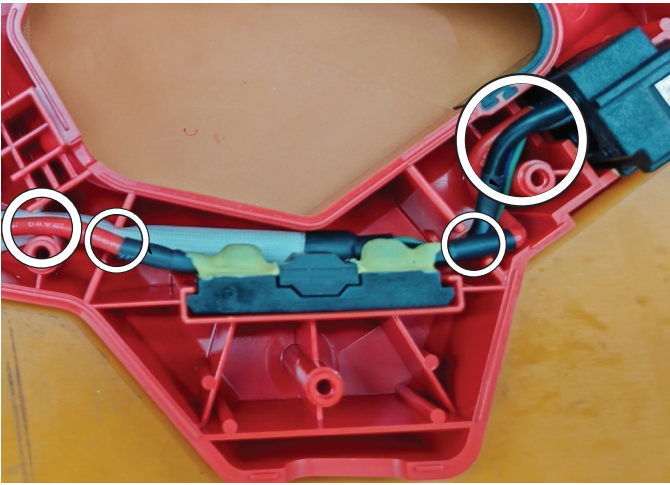

The fuse and holder fit into slot as shown above. Be sure to fit wires into guides and traps.

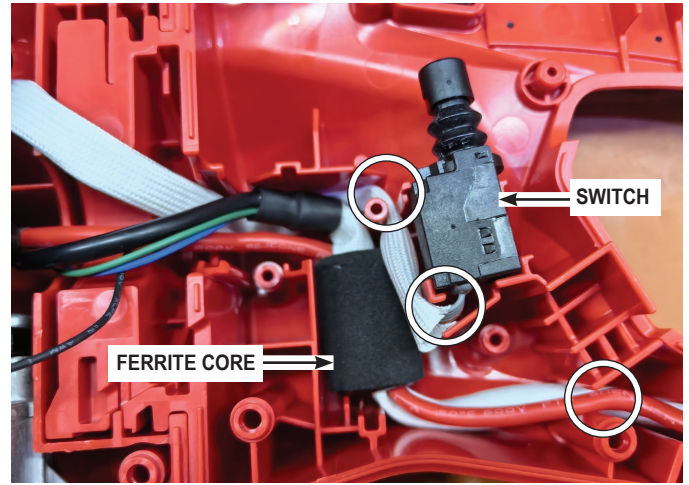

Fit the trigger switch and ferrite core into housing as shown above, securing the wires into traps.

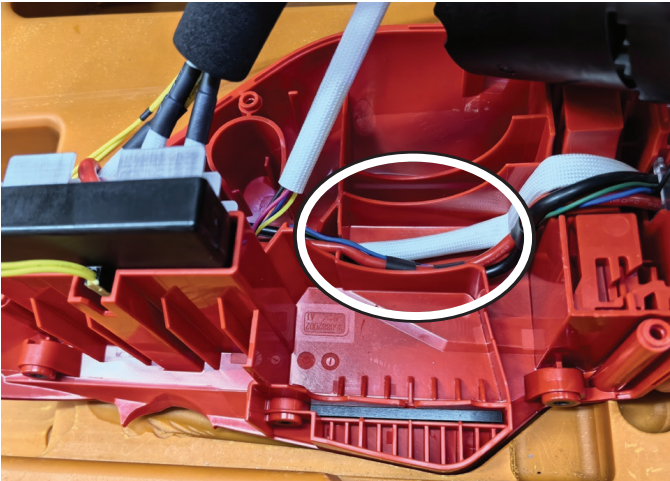

Wires should be located at the bottom of the housing support as shown.

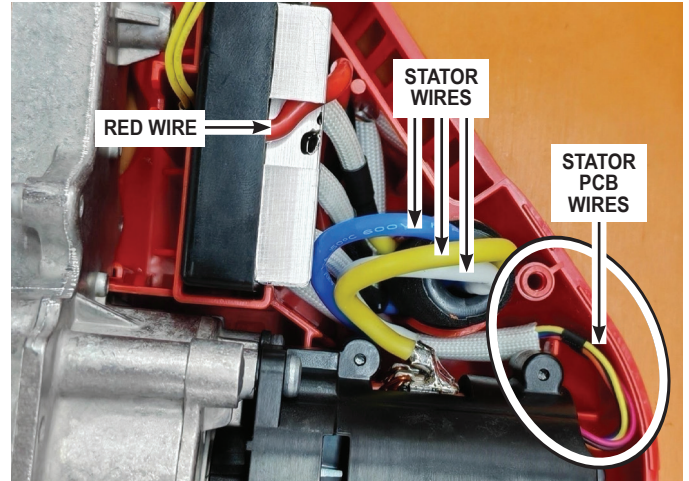

The stator PCB wires should go through rib traps as shown. Keep the red wire as far away from the three stator wires as shown.

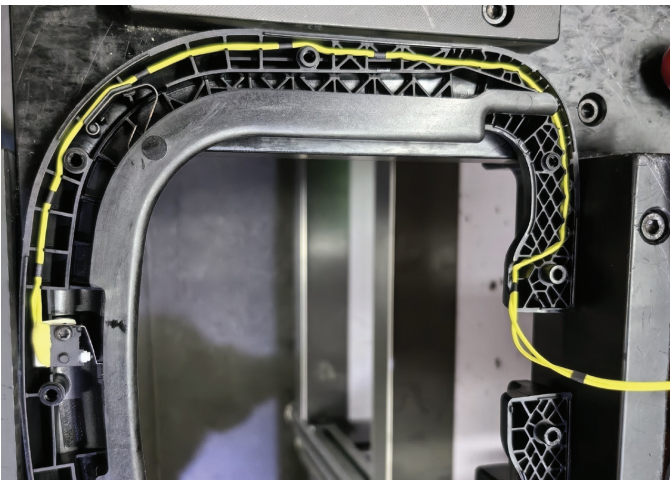

Yellow wires must be seated in the slots of bail handle as shown above.

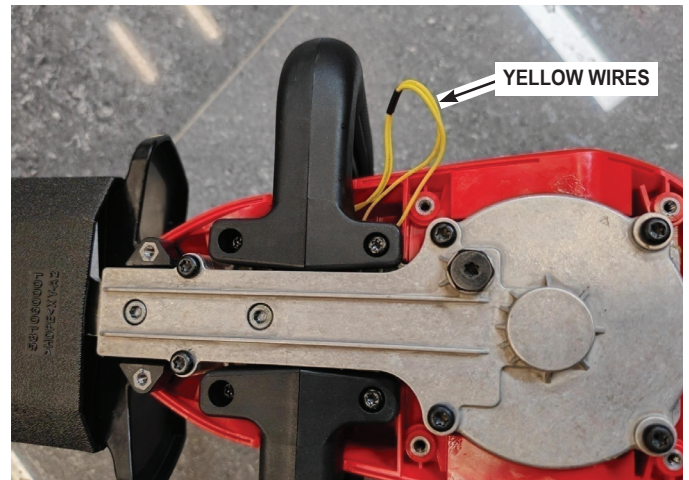

Pull the yellow wires out before assembling the bail handle.

BLADE REPLACEMENT INSTALLATION

**ALWAYS REMOVE BATTERY PACK
BEFORE PERFORMING ANY
MAINTENANCE REPAIRS**

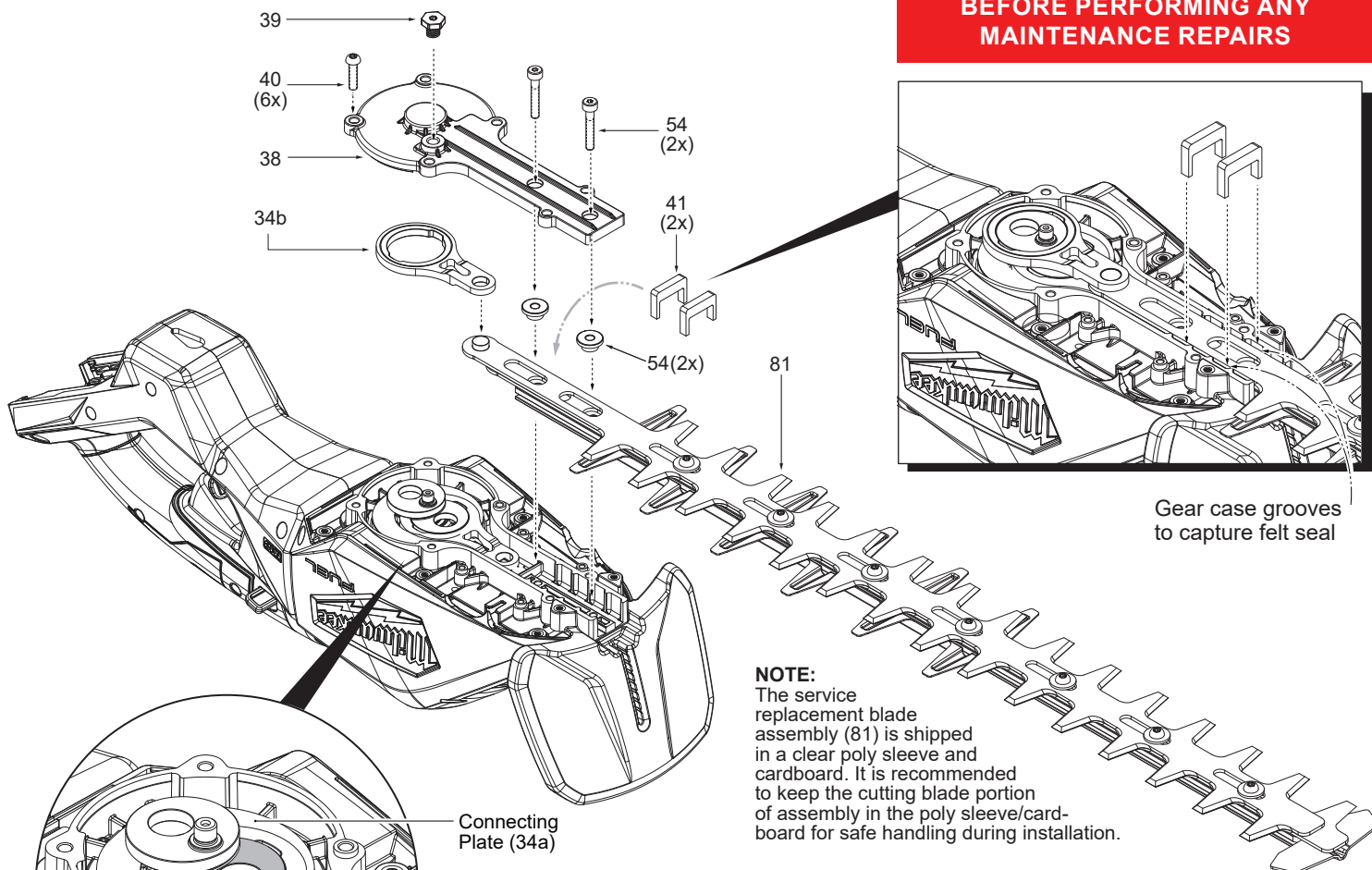

NOTE:

The service replacement blade assembly (81) is shipped in a clear poly sleeve and cardboard. It is recommended to keep the cutting blade portion of assembly in the poly sleeve/cardboard for safe handling during installation.

INSTALLING REPLACEMENT BLADE ASSEMBLY (Model 3033-20 Shown)

• Remove battery pack

- Be sure top of Connecting Plate (34a) is flush with surface 'A' of the eccentric on the Gear/Crank Shaft (33).
- Install new Blade Assembly (81) onto connecting plate (34a) as shown by placing the hole of the blade assembly over the lug on the connecting plate.
- **As an aid to keeping the connecting plate (34a) flush to the 'A' surface of the eccentric,** support the tool housing on one end being sure the bottom of the gear case is parallel with the work surface. Place a 3-1/2" wood block on the other end under the tip of the replacement blade assembly, *see illustration below*.
- Place Connecting Plate (34b) over the bearing and onto the eccentric of the Gear/Crank Shaft (33). Place the lug of connecting plate (34b) into the hole of the blade assembly.

NOTE: An instrument such as a nail or small screwdriver may have to be inserted into the exhaust vent to rotate the fan so the eccentric can turn and line up the hole with the lug. Be sure eccentric surface 'B' is flush with the top surface of connecting plate (34b).

- Place Felt Seal (41) over the blade assembly. Tuck each end down into grooves on gear case.
- Place a light coating of lubrication onto the Bushings (54) and place onto slots of blade assembly.
- Place a drop of red locking sealant onto the threads of screws (53). Insert screws through the bushings and secure to the gear case.
- Place Gear Case Cover (38) onto gear case and secure with six screws (40).
- Place Bottom Front Cover (42) over gear case cover and secure with eight screws (43). See page 2 for visual of items 42 and 43.
- Install battery and check for functionality.

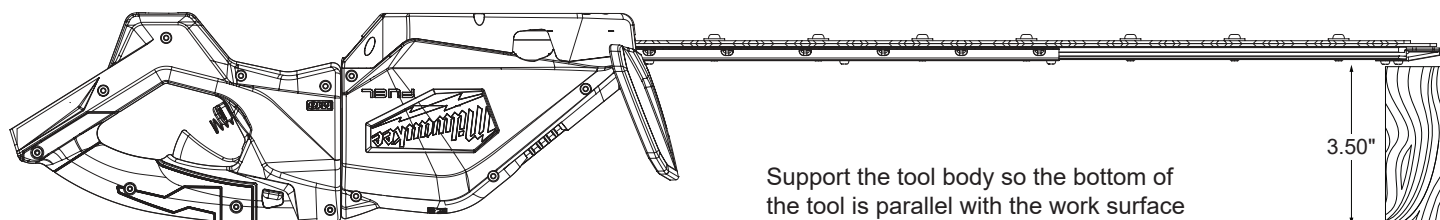
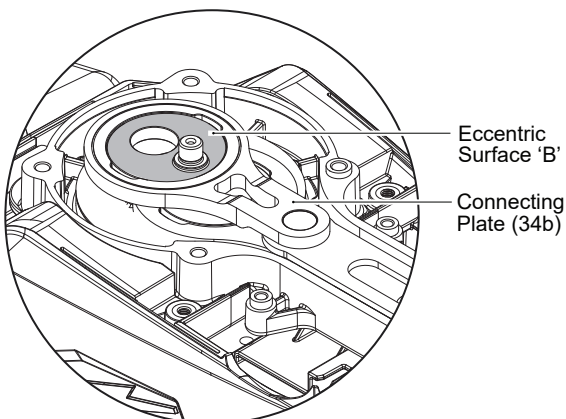

LUBRICATION INSTRUCTIONS

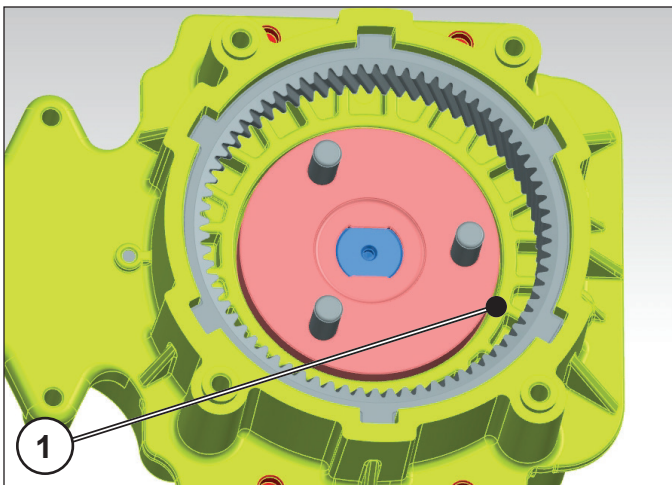

1) Apply approximately 15 grams of DECH 5157 grease onto the profile of the gear as shown above.

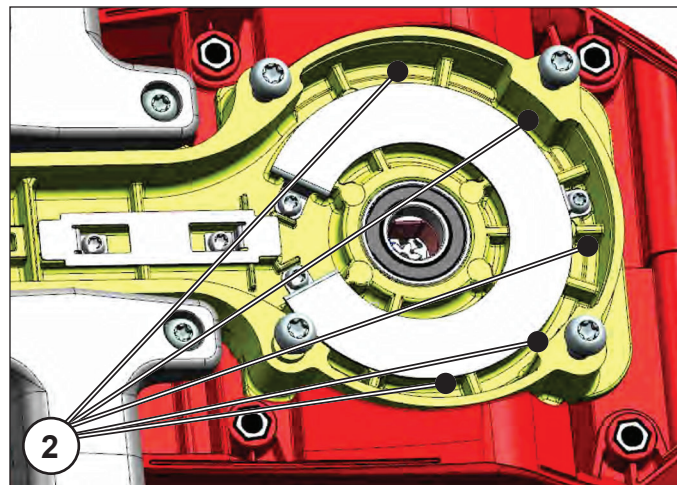

2) Apply approximately 9 grams of DECH 5157 grease as shown above and connect Rod Surface (Low) and Wear Plate Upper Gearcase (30).

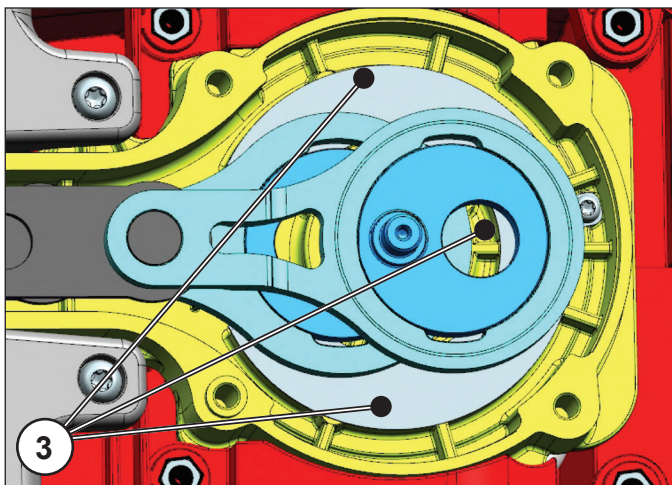

3) Apply approximately 9 grams of DECH 5157 grease as shown above and connect Rod Surface (Low) and Blade Groove.

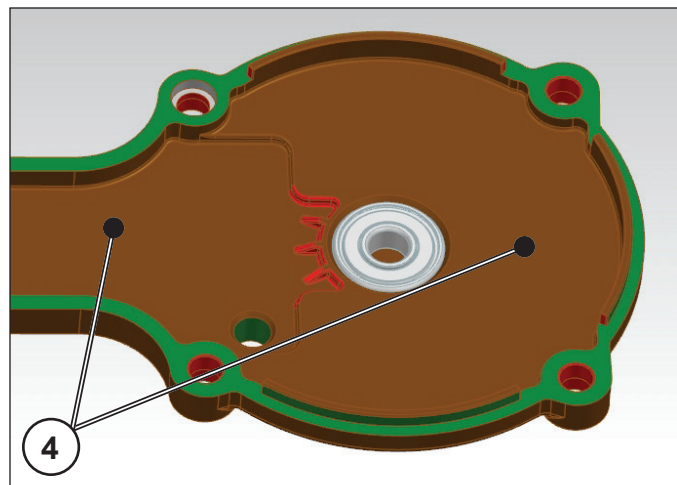

4) Apply approximately 2 grams of DECH 5157 grease as shown above and connect Wear Plate (35) and Gearcase Cover (36).

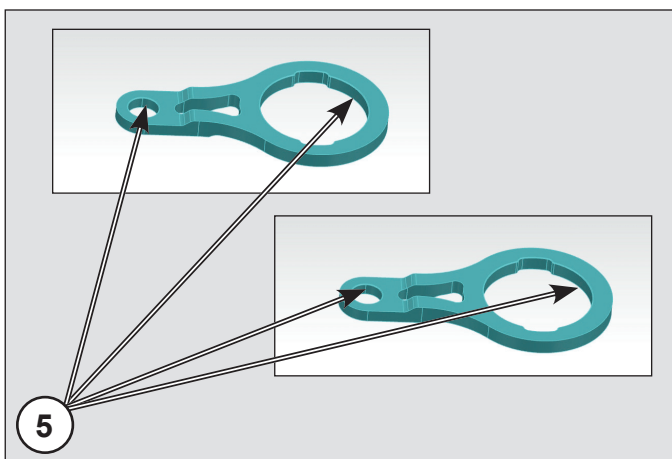

5) Apply approximately 1 gram of DECH 5157 grease as shown to EACH of the inner rings of the Connecting Rods (34a & 34b).